

CW68 DC открывалка

[Цепь цепей электрических цепей](#) с электронным управлением тяжелая защита от перегрузки, устройство изготовлено из высококачественной стали, материал наружного - алюминиевый сплав хорошего качества. наш [электрический стеклоподъемник](#) особенно используется корпус в верхней части окна открытия и закрытия.



DC WINDOW OPENER

STRUCTURE EXPLANATION

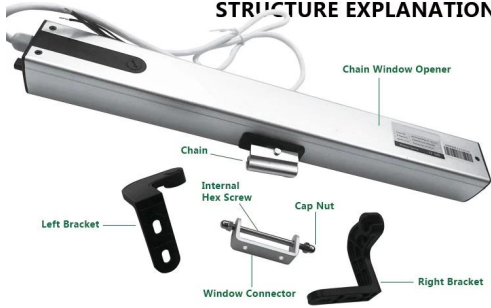

DIMENSIONS



DC24V power supply, mainly applied to the windows are mounted in high position, where people hard to operate. Safety voltage applied for building fire certification. It is popular installed in many famous commercial buildings for ventilation and security.

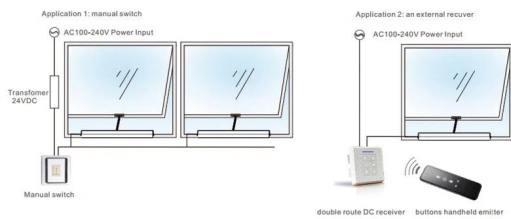

Features

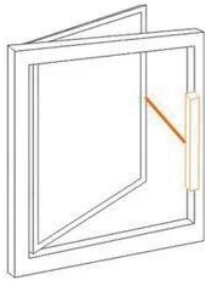

Casement Window (Left)

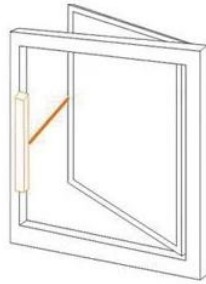

Casement Window (Right)

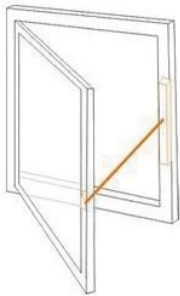

Casement Window Opening Inwards

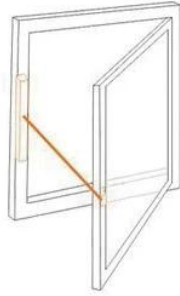

Casement Window Opening Inwards



Top-hinged Out-swinging Window



Top-hinged In-swinging Window



Hopper Window

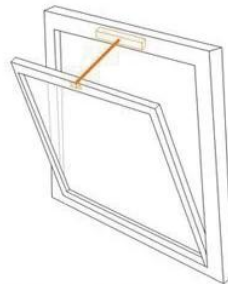

Horizontal Pivoting Window



1. Elegant design with quality surface finishing.
2. 24V DC electricity supplying.
3. Adjust the journey by adjusting knob, Convenient and quick.
4. Two flame resistance ABS holders and the POM sliding guide make the motor more silent and safer.
5. Automatically stop on physical obstruction; protect the motor and the user.
6. SMT assembly, damp-proof on surface.



Parameters

Модель №.	Номинальное напряжение	Рабочий ток	скорость	Запуск поездки	Push / Pull Force	температура	Размер	Класс IP
CW68-D250N / 400мм	DC24V	40W	10 мм / сек	100 ~ 400мм	250N	-20 °C ~ 60 °C	460 * 42 * 56мм	IP42