

Abridor de janela DC CW68

[Cadeia elétrica do motor da corrente](#) é com controle eletrônico de proteção contra sobrecarga pesada, o dispositivo é feito de aço de alta qualidade, o material de exterior é de boa qualidade em liga de alumínio. Nosso [abridor de janela elétrica](#) é habitação especialmente usada no topo da abertura e fechamento da janela.



DC WINDOW OPENER

STRUCTURE EXPLANATION

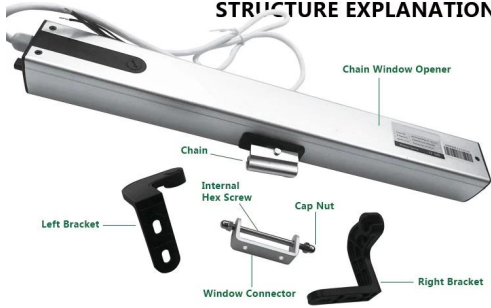

DIMENSIONS



DC24V power supply, mainly applied to the windows are mounted in high position, where people hard to operate. Safety voltage applied for building fire certification. It is popular installed in many famous commercial buildings for ventilation and security.

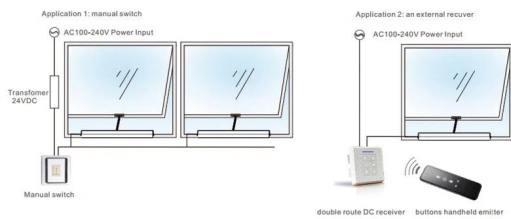

Features

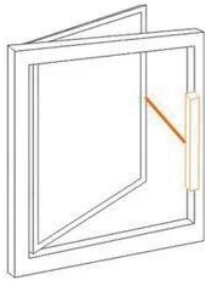

Casement Window (Left)

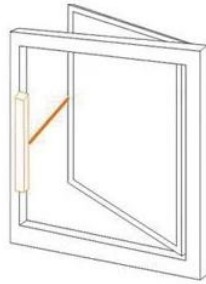

Casement Window (Right)

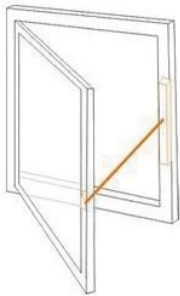

Casement Window Opening Inwards

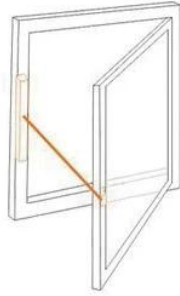

Casement Window Opening Inwards



Top-hinged Out-swinging Window



Top-hinged In-swinging Window



Hopper Window

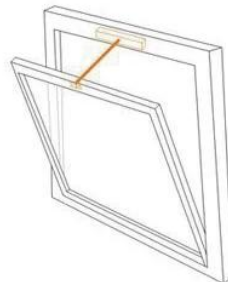

Horizontal Pivoting Window



1. Elegant design with quality surface finishing.
2. 24V DC electricity supplying.
3. Adjust the journey by adjusting knob, Convenient and quick.
4. Two flame resistance ABS holders and the POM sliding guide make the motor more silent and safer.
5. Automatically stop on physical obstruction; protect the motor and the user.
6. SMT assembly, damp-proof on surface.



Parameters

Modelo No.	Tensão nominal	Trabalho atual	Rapidez	Viagem corrida	Push / Pull Force	Temp	Tamanho	Classe IP
CW68-D250N / 400mm	DC24V	40W	10mm / s	100 ~ 400mm	250N	-20 °C ~ + 60 °C	460 * 42 * 56mm	IP42