

CW68 DC window opener

[Electric Chain Motor chain](#) is with electronic control heavy overload protection, device is made of high quality steel, Material of outer is good quality aluminum alloy. Our [electric window opener](#) is especially used housing at the top of the window opening and closing.



DC WINDOW OPENER

STRUCTURE EXPLANATION

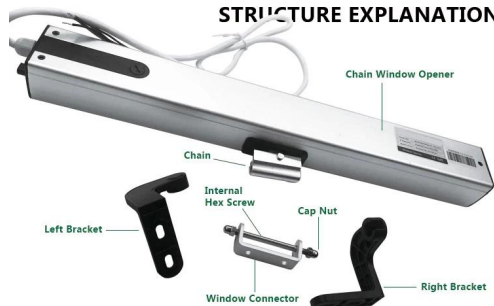

DIMENSIONS



CENTER PIVOTED WINDOW



HOPPER WINDOW

DC24V power supply, mainly applied to the windows are mounted in high position, where people hard to operate. Safety voltage applied for building fire certification. It is popular installed in many famous commercial buildings for ventilation and security.

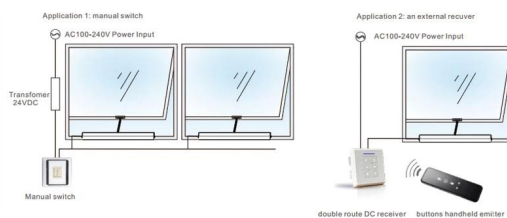

Features

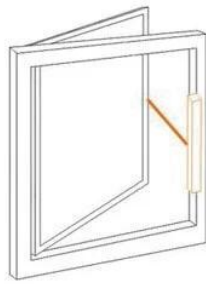

Casement Window (Left)

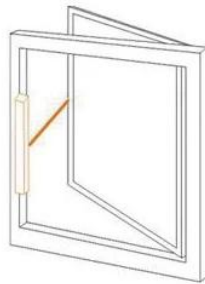

Casement Window (Right)

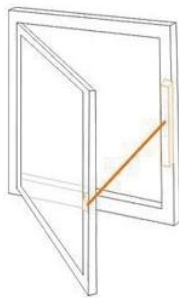

Casement Window Opening Inwards

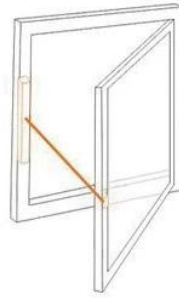

Casement Window Opening Inwards



Top-hinged Out-swinging Window



Top-hinged In-swinging Window



Hopper Window

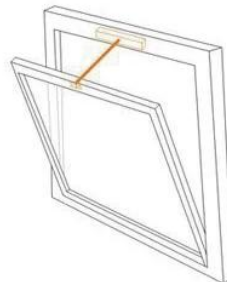

Horizontal Pivoting Window



- 1.Elegant design with quality surface finishing.
- 2.24V DC electricity supplying.
- 3.Adjust the journey by adjusting knob,
Convenient and quick.
- 4.Two flame resistance ABS holders and the POM
sliding guide make the motor more silent and safer.
- 5.Automatically stop on physical obstruction; protect
the motor and the user.
- 6.SMT assembly, damp-proof on surface.



Parameters

Model No.	Rated Voltage	Working Current	Speed	Running Trip	Push/Pull Force	Temp	Size	IP Class
CW68-D250N/400mm	DC24V	40W	10mm/s	100~400mm	250N	-20℃~+60℃	460*42*56mm	IP42