

Abridor de ventana DC CW68

[Cadena de cadena de motor eléctrico](#) es con control electrónico de protección de sobrecarga pesada, el dispositivo está hecho de acero de alta calidad, el material de exterior es de buena calidad de aleación de aluminio. Nuestra [abrelatas eléctrico](#) Se utiliza especialmente la vivienda en la parte superior de la ventana para abrir y cerrar.



DC WINDOW OPENER

STRUCTURE EXPLANATION

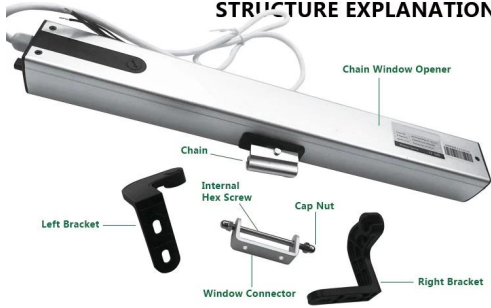

DIMENSIONS



DC24V power supply, mainly applied to the windows are mounted in high position, where people hard to operate. Safety voltage applied for building fire certification. It is popular installed in many famous commercial buildings for ventilation and security.

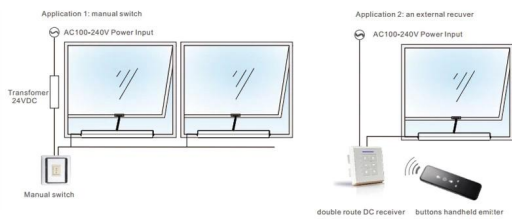

Features

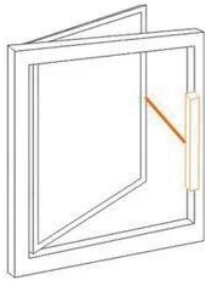

Casement Window (Left)

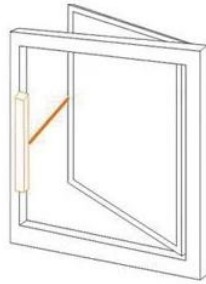

Casement Window (Right)

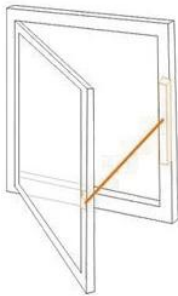

Casement Window Opening Inwards

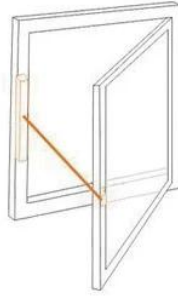

Casement Window Opening Inwards



Top-hinged Out-swinging Window



Top-hinged In-swinging Window



Hopper Window

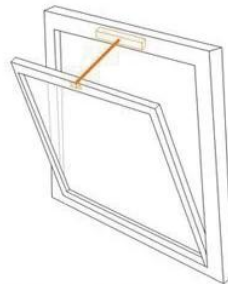

Horizontal Pivoting Window



1. Elegant design with quality surface finishing.
2. 24V DC electricity supplying.
3. Adjust the journey by adjusting knob, Convenient and quick.
4. Two flame resistance ABS holders and the POM sliding guide make the motor more silent and safer.
5. Automatically stop on physical obstruction; protect the motor and the user.
6. SMT assembly, damp-proof on surface.



Parameters

N ° de Modelo.	Voltaje nominal	Corriente de trabajo	Velocidad	Corriendo viaje	Fuerza de empuje / tracción	Temperatura	tamaño	Clase de IP
CW68-D250N / 400mm	DC24V	40W	10 mm / s	100 ~ 400 mm	250N	-20 °C ~ + 60 °C	460 * 42 * 56 mm	IP42