

CW68 DC 000 000

00.00.00.00 00 00 000 000 000 00, 000 0000 0000 0000, 000 000 00 000 0000 00000. 000 00.0.00 00 0000 00
000 0000 00000.



DC WINDOW OPENER

STRUCTURE EXPLANATION

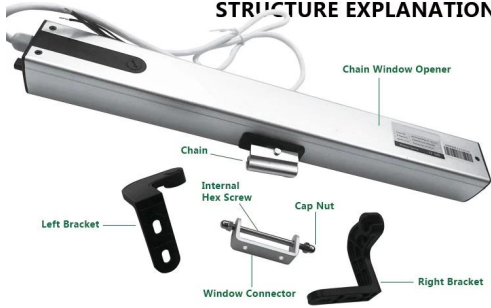

DIMENSIONS



DC24V power supply, mainly applied to the windows are mounted in high position, where people hard to operate. Safety voltage applied for building fire certification. It is popular installed in many famous commercial buildings for ventilation and security.

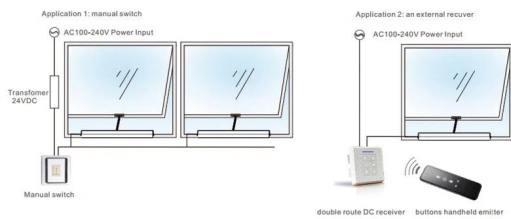

Features

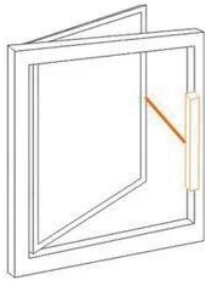

Casement Window (Left)

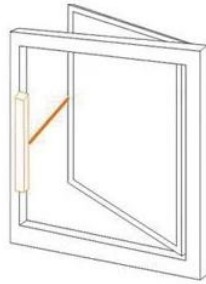

Casement Window (Right)

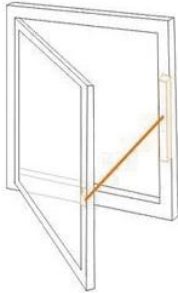

Casement Window Opening Inwards

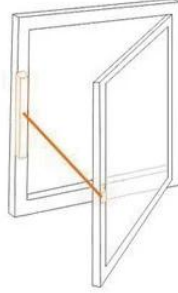

Casement Window Opening Inwards



Top-hinged Out-swinging Window



Top-hinged In-swinging Window



Hopper Window

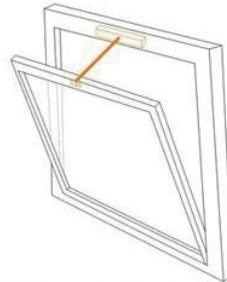

Horizontal Pivoting Window



1. Elegant design with quality surface finishing.
2. 24V DC electricity supplying.
3. Adjust the journey by adjusting knob, Convenient and quick.
4. Two flame resistance ABS holders and the POM sliding guide make the motor more silent and safer.
5. Automatically stop on physical obstruction; protect the motor and the user.
6. SMT assembly, damp-proof on surface.



Parameters

Model	Supply Voltage	Power	Stroke	Stroke Length	Force	Temperature Range	Dimensions	IP Rating
CW68-D250N / 400mm	DC24V	40W	10mm / s	100 ~ 400mm	250N	-20 °C ~ + 60 °C	460 * 42 * 56mm	IP42