

CW68 000000 00000 00

00 000000 000000 000000000 000000 00000 00000000000 000000 00 00 000000-000000-00000000000-000000
00000000 000000000-000000-00000 0000 .00000000000 000000 00000 00000 00 00000000 00000 0000000 000000 00000
00000000 0000 000000 00 00000000 000000 00 00000000 0000 00000.



DC WINDOW OPENER

STRUCTURE EXPLANATION

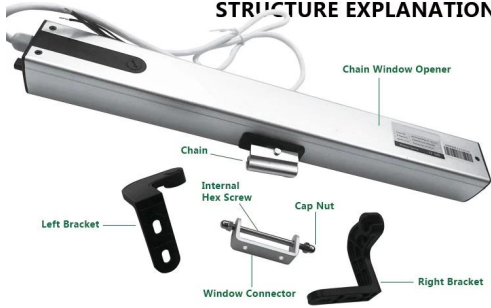

DIMENSIONS



DC24V power supply, mainly applied to the windows are mounted in high position, where people hard to operate. Safety voltage applied for building fire certification. It is popular installed in many famous commercial buildings for ventilation and security.

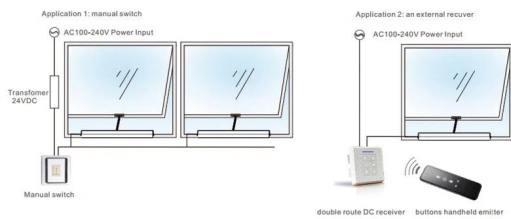

Features

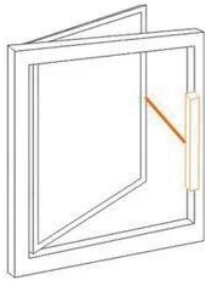

Casement Window (Left)

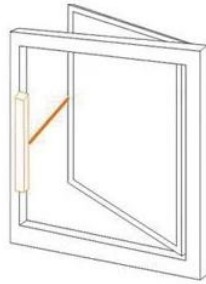

Casement Window (Right)

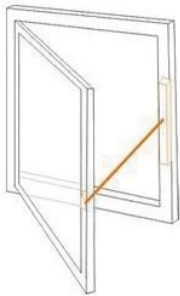

Casement Window Opening Inwards

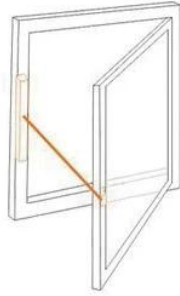

Casement Window Opening Inwards



Top-hinged Out-swinging Window



Top-hinged In-swinging Window



Hopper Window

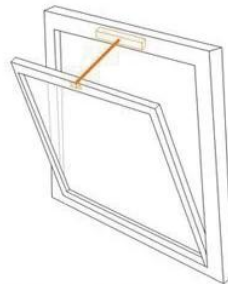

Horizontal Pivoting Window



1. Elegant design with quality surface finishing.
2. 24V DC electricity supplying.
3. Adjust the journey by adjusting knob, Convenient and quick.
4. Two flame resistance ABS holders and the POM sliding guide make the motor more silent and safer.
5. Automatically stop on physical obstruction; protect the motor and the user.
6. SMT assembly, damp-proof on surface.



Parameters

Model Name:	Input Voltage	Power Consumption	Mounting Hole Diameter	Mounting Hole Spacing	Mounting Torque	Operating Temperature	Dimensions (W * H * D)	IP Rating
CW68-D250N / 400MM	DC24V	40W	10MM / Ø	100 ~ 400MM	250N	-20 °C ~ + 60 °C	460 * 42 * 56MM	IP42